



GST NO.: 29AHZPU5620Q1ZZ

An ISO 9001:2015 Certified Company

# ROYAL INDUSTRIAL SUPPLIERS

QUALITY FASTENERS SPECIALIST



8310165941 / 9959457863



sales@royalfastenersindia.com



www.royalfastenersindia.com

## TECHNICAL DATA SHEET

### ALLEN BUTTON HEAD CAP SCREW (BHCS)



MATERIAL- STAINLESS STEEL

GRADE-SS316 (A4-70)

AS PER-ANSI/ASME-B18.3-3

CATALOGUE NO. R6C22u

### INSTALLATION GUIDE

- SELECT THE CORRECT SIZE OF ALLEN BHCS SCREW AND MATCHING ALLEN KEY/HEX WRENCH.
- CHECK THAT THE MATING HOLE OR THREAD IS CLEAN AND FREE FROM DUST, OIL, OR DEBRIS.
- POSITION THE COMPONENTS TO BE FASTENED IN PROPER ALIGNMENT.
- INSERT THE ALLEN BHCS SCREW INTO THE HOLE BY HAND TO AVOID CROSS THREADING.
- USE THE ALLEN KEY/HEX WRENCH TO TIGHTEN THE SCREW CLOCKWISE.
- APPLY STEADY AND EVEN FORCE TO AVOID DAMAGING THE SOCKET.
- DO NOT OVERTIGHTEN TO PREVENT STRIPPING THREADS OR DISTORTING THE MATERIAL.
- USE A TORQUE WRENCH IF SPECIFIC TORQUE VALUES ARE PROVIDED.
- FOR VIBRATION-PRONE APPLICATIONS, CONSIDER USING A WASHER OR THREAD LOCKING COMPOUND.
- VERIFY THAT THE ALLEN BHCS SCREW IS FIRMLY SECURED AND THE BUTTON HEAD IS PROPERLY SEATED ON THE SURFACE.

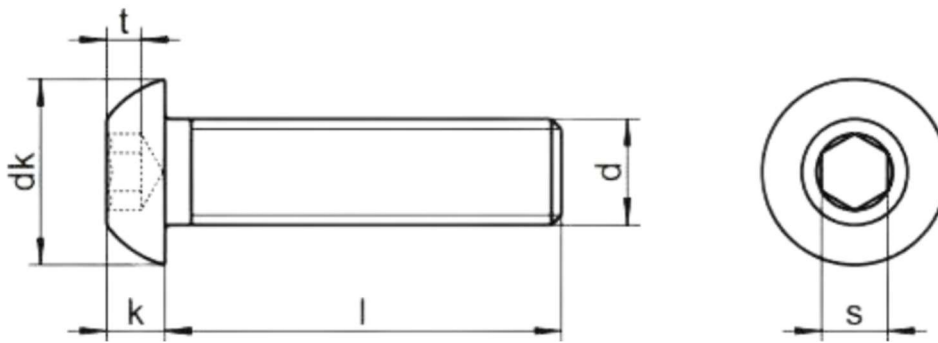

**UNC SERIES**

**Thread Class - 2A**

Dim ↓ Size →	#2-56	#4-40	#6-32	#8-32	#10-24	
Head Dia dk	max	0.166	0.203	0.264	0.314	0.363
	min	0.152	0.199	0.248	0.296	0.345
Major Dia d	max	0.086	0.112	0.138	0.164	0.190
	min	0.0822	0.1075	0.1329	0.1585	0.1840
Head Height k	max	0.048	0.061	0.075	0.089	0.103
	min	0.036	0.049	0.061	0.075	0.089
Socket s	0.050	0.062	0.078	0.094	0.125	
Key Size	1/20	1/16	5/64	3/32	1/8	

Quote the PART NUMBER given below with your order/ inquiries:

All Dimensions in Inches

Length ↓ Size →	#2-56	#4-40	#6-32	#8-32	#10-24
3/16"	R6C22u25648	R6C22u44048			
1/4"	R6C22u25662	R6C22u44062	R6C22u63262	R6C22u83262	
5/16"	R6C22u25679	R6C22u44079	R6C22u63279	R6C22u83279	R6C22u12479
3/8"	R6C22u25691	R6C22u44091	R6C22u63291	R6C22u83291	R6C22u12491
1/2"	R6C22u25613	R6C22u44013	R6C22u63213	R6C22u83213	R6C22u12413
5/8"	R6C22u25615	R6C22u44015	R6C22u63215	R6C22u83215	R6C22u12415
3/4"	R6C22u25619	R6C22u44019	R6C22u63219	R6C22u83219	R6C22u12419
7/8"	R6C22u25623	R6C22u44023	R6C22u63223	R6C22u83223	R6C22u12423
1"	R6C22u25625	R6C22u44025	R6C22u63225	R6C22u83225	R6C22u12425
1-1/4"		R6C22u44031	R6C22u63231	R6C22u83231	R6C22u12431
1-1/2"		R6C22u44038	R6C22u63238	R6C22u83238	R6C22u12438
1-3/4"		R6C22u44044	R6C22u63244	R6C22u83244	R6C22u12444
2"		R6C22u44051	R6C22u63251	R6C22u83251	R6C22u12451
2-1/4"			R6C22u63256	R6C22u83256	R6C22u12456
2-1/2"			R6C22u63263	R6C22u83263	R6C22u12463
3"			R6C22u63276	R6C22u83276	R6C22u12476

Sizes in BLUE are non-preferred. Availability is limited and MOQ is applied. *Data is strictly informative*

Note: All Austenitic Stainless-Steel Fasteners may exhibit some Magnetic Properties due to the Manufacturing Process. Refer: ISO 3506-2 Annex F

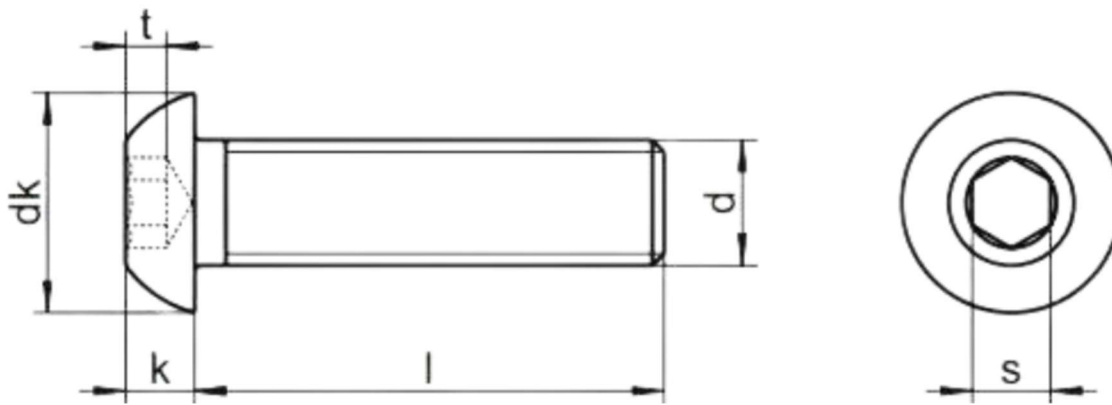

**UNC SERIES**

<b>Thread Class - 2A</b>						
Dim ↓ Size →		1/4-20	5/16-18	3/8-16	1/2-13	5/8-11
Head Dia D	max	0.439	0.550	0.659	0.878	1.040
	min	0.417	0.524	0.633	0.848	0.930
Major Dia d	max	0.250	0.3125	0.375	0.500	0.625
	min	0.2435	0.3053	0.3678	0.4919	0.6163
Head Height k	max	0.134	0.168	0.201	0.268	0.334
	min	0.120	0.150	0.183	0.242	0.308
Socket s		0.156	0.188	0.219	0.312	0.375
Key Size		5/32	3/16	7/32	5/16	3/8

Quote the PART NUMBER given below with your order/ inquiries: All Dimensions in Inches

Length ↓ Size →	1/4-20	5/16-18	3/8-16	1/2-13	5/8-11
3/8"	R6C22u62091	R6C22u79019			
1/2"	R6C22u62013	R6C22u79013	R6C22u91013		
5/8"	R6C22u62015	R6C22u79015	R6C22u91015	R6C22u13015	
3/4"	R6C22u62019	R6C22u79019	R6C22u91019	R6C22u13019	
7/8"	R6C22u62023	R6C22u79023	R6C22u91023	R6C22u13023	
1"	R6C22u62025	R6C22u79025	R6C22u91025	R6C22u13025	R6C22u15025
1-1/4"	R6C22u62031	R6C22u79031	R6C22u91031	R6C22u13031	R6C22u15031
1-1/2"	R6C22u62038	R6C22u79038	R6C22u91038	R6C22u13038	R6C22u15038
1-3/4"	R6C22u62044	R6C22u79044	R6C22u91044	R6C22u13044	R6C22u15044
2"	R6C22u62051	R6C22u79051	R6C22u91051	R6C22u13051	R6C22u15051
2-1/4"	R6C22u62056	R6C22u79056	R6C22u91056	R6C22u13056	R6C22u15056
2-1/2"	R6C22u62063	R6C22u79063	R6C22u91063	R6C22u13063	R6C22u15063
3"	R6C22u62076	R6C22u79076	R6C22u91076	R6C22u13076	R6C22u15076
3-1/2"	R6C22u62089	R6C22u79089	R6C22u91089	R6C22u13089	R6C22u15089
4"	R6C22u62102	R6C22u79102	R6C22u91102	R6C22u13102	R6C22u15102
5"	R6C22u62126	R6C22u79126	R6C22u91126	R6C22u13126	R6C22u15126

Sizes in BLUE are non-preferred. Availability is limited and MOQ is applied. *Data is strictly informative*