



GST NO.: 29AHZPU5620Q1ZZ

An ISO 9001:2015 Certified Company

ROYAL INDUSTRIAL SUPPLIERS

QUALITY FASTENERS SPECIALIST



8310165941 / 9959457863



sales@royalfastenersindia.com



www.royalfastenersindia.com

TECHNICAL DATA SHEET

ALLEN CSK



MATERIAL- STAINLESS STEEL

GRADE-SS304 (A2-70)

AS PER-ISO-10642 ≈ DIN-7991

CATALOGUE NO. R4C21

INSTALLATION GUIDE

- SELECT THE CORRECT SIZE OF ALLEN CSK SCREW AND MATCHING ALLEN KEY/HEX WRENCH.
- ENSURE THE COUNTERSUNK HOLE IS PREPARED TO MATCH THE SCREW ANGLE FOR FLUSH FITTING.
- CLEAN THE MATING SURFACE AND HOLE TO REMOVE DUST, OIL, OR DEBRIS.
- POSITION THE COMPONENTS ACCURATELY BEFORE INSERTING THE SCREW.
- INSERT THE ALLEN CSK SCREW INTO THE COUNTERSUNK HOLE BY HAND TO AVOID CROSS THREADING.
- USE THE ALLEN KEY/HEX WRENCH TO TIGHTEN THE SCREW CLOCKWISE.
- APPLY UNIFORM FORCE TO ENSURE THE SCREW HEAD SITS FLUSH WITH THE MATERIAL SURFACE.
- DO NOT OVERTIGHTEN TO PREVENT DAMAGE TO THE MATERIAL OR THREADS.
- USE A TORQUE WRENCH IF SPECIFIC TORQUE VALUES ARE REQUIRED.
- INSPECT THE INSTALLATION TO CONFIRM THE SCREW HEAD IS PROPERLY FLUSH AND SECURE.

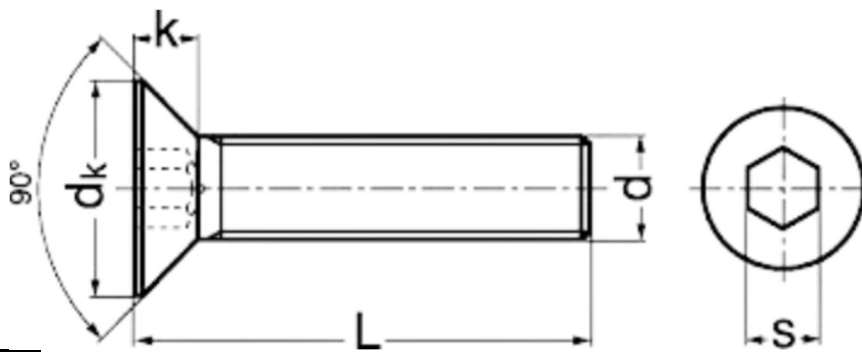

Note: *Non standard parts

Parameter↓/Dia→	*M2x0.4	*M2.5x0.45	M3x0.5	M4x0.7	M5x0.8	M6x1.0
dk Max	4.10	5.10	6.72	8.96	11.20	13.44
dk Min	3.70	4.75	5.54	7.53	9.43	11.34
Socket A/F s	1.30	1.50	2.00	2.50	3.00	4.00
S	1.30	1.50	2.00	2.50	3.00	4.00
k Max	1.45	1.79	1.96	2.58	3.20	3.82
t Max	0.85	1.15	1.20	1.80	2.30	2.50

Quote the PART NUMBER given below with your order/ inquiries:

All Dimensions in mm

Length↓/Dia→	*M2x0.4	*M2.5x0.45	M3x0.5	M4x0.7	M5x0.8	M6x1.0
3	R4C2102003	R4C2120503				
4	R4C2102004	R4C2120504	R4C2103004			
5	R4C2102005	R4C2120505	R4C2103005	R4C2104005		
6	R4C2102006	R4C2120506	R4C2103006	R4C2104006	R4C2105006	
8	R4C2102008	R4C2120508	R4C2103008	R4C2104008	R4C2105008	R4C2106008
10	R4C2102010	R4C2120510	R4C2103010	R4C2104010	R4C2105010	R4C2106010
12	R4C2102012	R4C2120512	R4C2103012	R4C2104012	R4C2105012	R4C2106012
14	R4C2102014	R4C2120514	R4C2103014	R4C2104014	R4C2105014	R4C2106014
16	R4C2102016	R4C2120516	R4C2103016	R4C2104016	R4C2105016	R4C2106016
18	R4C2102018	R4C2120518	R4C2103018	R4C2104018	R4C2105018	R4C2106018
20	R4C2102020	R4C2120520	R4C2103020	R4C2104020	R4C2105020	R4C2106020
22	R4C2102022	R4C2120522	R4C2103022	R4C2104022	R4C2105022	R4C2106022
25	R4C2102025	R4C2120525	R4C2103025	R4C2104025	R4C2105025	R4C2106025
30	R4C2102030	R4C2120530	R4C2103030	R4C2104030	R4C2105030	R4C2106030
35	R4C2102035	R4C2120535	R4C2103035	R4C2104035	R4C2105035	R4C2106035
40	R4C2102040	R4C2120540	R4C2103040	R4C2104040	R4C2105040	R4C2106040
45	R4C2102045	R4C2120545	R4C2103045	R4C2104045	R4C2105045	R4C2106045
50	R4C2102050	R4C2120550	R4C2103050	R4C2104050	R4C2105050	R4C2106050
55			R4C2103055	R4C2104055	R4C2105055	R4C2106055
60			R4C2103060	R4C2104060	R4C2105060	R4C2106060
65			R4C2103065	R4C2104065	R4C2105065	R4C2106065
70			R4C2103070	R4C2104070	R4C2105070	R4C2106070
75			R4C2103075	R4C2104075	R4C2105075	R4C2106075
80			R4C2103080	R4C2104080	R4C2105080	R4C2106080
90			R4C2103090	R4C2104090	R4C2105090	R4C2106090
100			R4C2103100	R4C2104100	R4C2105100	R4C2106100

Sizes in BLUE are non-preferred. Availability is limited and MOQ is applied. Data is strictly informative

Note: All Austenitic Stainless-Steel Fasteners may exhibit some Magnetic Properties due to the Manufacturing Process.

Refer: ISO 3506-2 Annex F

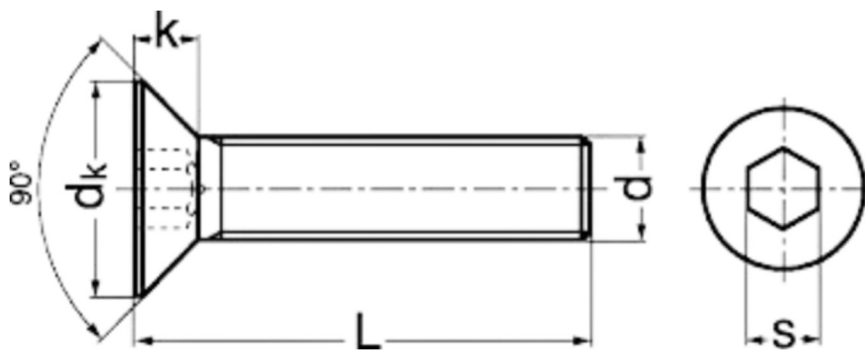

Note: *Non standard parts

Parameter↓/Dia→	M8x1.25	M10x1.5	M12x1.75	M16x2.0	M20x2.5	M24x3.0
dk Max	17.92	22.40	26.88	33.60	40.32	41.00
dk Min	15.24	19.22	23.12	29.01	35.38	38.38
Socket A/F s	5.00	6.00	8.00	10.00	12.00	14.00
S	5.00	6.00	8.00	10.00	12.00	14.00
k Max	5.06	6.30	7.54	8.90	10.26	14.10
t Max	3.50	4.40	4.60	5.30	5.90	10.30

Quote the PART NUMBER given below with your order/ inquiries:

All Dimensions in mm

Length↓/Dia→	M8x1.25	M10x1.5	M12x1.75	M16x2.0	M20x2.5	M24x3.0
10	R4C2108010					
12	R4C2108012	R4C2110012				
14	R4C2108014	R4C2110014				
16	R4C2108016	R4C2110016	R4C2112016			
18	R4C2108018	R4C2110018	R4C2112018			
20	R4C2108020	R4C2110020	R4C2112020	R4C2116020		
22	R4C2108022	R4C2110022	R4C2112022			
25	R4C2108025	R4C2110025	R4C2112025	R4C2116025		
30	R4C2108030	R4C2110030	R4C2112030	R4C2116030	R4C2120030	
35	R4C2108035	R4C2110035	R4C2112035	R4C2116035	R4C2120035	
40	R4C2108040	R4C2110040	R4C2112040	R4C2116040	R4C2120040	R4C2124040
45	R4C2108045	R4C2110045	R4C2112045	R4C2116045	R4C2120045	R4C2124045
50	R4C2108050	R4C2110050	R4C2112050	R4C2116050	R4C2120050	R4C2124050
55	R4C2108055	R4C2110055	R4C2112055	R4C2116055	R4C2120055	R4C2124055
60	R4C2108060	R4C2110060	R4C2112060	R4C2116060	R4C2120060	R4C2124060
65	R4C2108065	R4C2110065	R4C2112065	R4C2116065	R4C2120065	R4C2124065
70	R4C2108070	R4C2110070	R4C2112070	R4C2116070	R4C2120070	R4C2124070
75	R4C2108075	R4C2110075	R4C2112075	R4C2116075	R4C2120075	R4C2124075
80	R4C2108080	R4C2110080	R4C2112080	R4C2116080	R4C2120080	R4C2124080
90	R4C2108090	R4C2110090	R4C2112090	R4C2116090	R4C2120090	R4C2124090
100	R4C2108100	R4C2110100	R4C2112100	R4C2116100	R4C2120100	R4C2124100

Sizes in BLUE are non-preferred. Availability is limited and MOQ is applied. Data is strictly informative

Note: All Austenitic Stainless-Steel Fasteners may exhibit some Magnetic Properties due to the Manufacturing Process.

Refer: ISO 3506-2 Annex F