



GST NO.: 29AHZPU5620Q1ZZ

An ISO 9001:2015 Certified Company

ROYAL INDUSTRIAL SUPPLIERS

QUALITY FASTENERS SPECIALIST



8310165941 / 9959457863



sales@royalfastenersindia.com



www.royalfastenersindia.com

TECHNICAL DATA SHEET

ALLEN CSK



MATERIAL- STAINLESS STEEL

GRADE-SS316 (A4-70)

AS PER-ISO-10642 ≈ DIN-7991

CATALOGUE NO. R6C21

INSTALLATION GUIDE

- SELECT THE CORRECT SIZE OF ALLEN CSK SCREW AND MATCHING ALLEN KEY/HEX WRENCH.
- ENSURE THE COUNTERSUNK HOLE IS PREPARED TO MATCH THE SCREW ANGLE FOR FLUSH FITTING.
- CLEAN THE MATING SURFACE AND HOLE TO REMOVE DUST, OIL, OR DEBRIS.
- POSITION THE COMPONENTS ACCURATELY BEFORE INSERTING THE SCREW.
- INSERT THE ALLEN CSK SCREW INTO THE COUNTERSUNK HOLE BY HAND TO AVOID CROSS THREADING.
- USE THE ALLEN KEY/HEX WRENCH TO TIGHTEN THE SCREW CLOCKWISE.
- APPLY UNIFORM FORCE TO ENSURE THE SCREW HEAD SITS FLUSH WITH THE MATERIAL SURFACE.
- DO NOT OVERTIGHTEN TO PREVENT DAMAGE TO THE MATERIAL OR THREADS.
- USE A TORQUE WRENCH IF SPECIFIC TORQUE VALUES ARE REQUIRED.
- INSPECT THE INSTALLATION TO CONFIRM THE SCREW HEAD IS PROPERLY FLUSH AND SECURE.

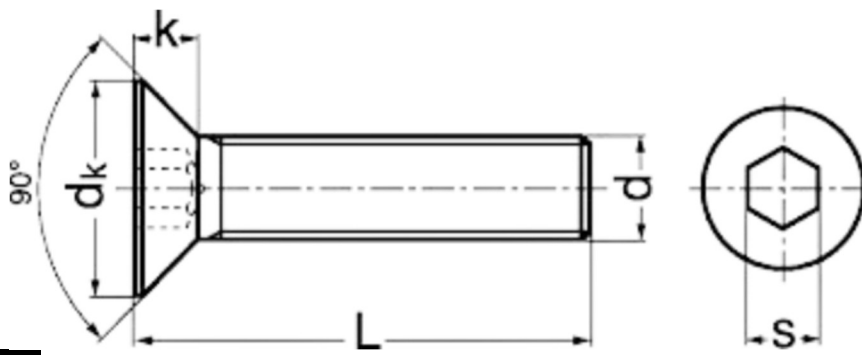

Note: *Non standard parts

Parameter↓/Dia→	*M2x0.4	*M2.5x0.45	M3x0.5	M4x0.7	M5x0.8	M6x1.0
dk Max	4.10	5.10	6.72	8.96	11.20	13.44
dk Min	3.70	4.75	5.54	7.53	9.43	11.34
Socket A/F s	1.30	1.50	2.00	2.50	3.00	4.00
S	1.30	1.50	2.00	2.50	3.00	4.00
k Max	1.45	1.79	1.96	2.58	3.20	3.82
t Max	0.85	1.15	1.20	1.80	2.30	2.50

Quote the PART NUMBER given below with your order/ inquiries:

All Dimensions in mm

Length↓/Dia→	*M2x0.4	*M2.5x0.45	M3x0.5	M4x0.7	M5x0.8	M6x1.0
3	R6C2102003	R6C2120503				
4	R6C2102004	R6C2120504	R6C2103004			
5	R6C2102005	R6C2120505	R6C2103005	R6C2104005		
6	R6C2102006	R6C2120506	R6C2103006	R6C2104006	R6C2105006	
8	R6C2102008	R6C2120508	R6C2103008	R6C2104008	R6C2105008	R6C2106008
10	R6C2102010	R6C2120510	R6C2103010	R6C2104010	R6C2105010	R6C2106010
12	R6C2102012	R6C2120512	R6C2103012	R6C2104012	R6C2105012	R6C2106012
14	R6C2102014	R6C2120514	R6C2103014	R6C2104014	R6C2105014	R6C2106014
16	R6C2102016	R6C2120516	R6C2103016	R6C2104016	R6C2105016	R6C2106016
18	R6C2102018	R6C2120518	R6C2103018	R6C2104018	R6C2105018	R6C2106018
20	R6C2102020	R6C2120520	R6C2103020	R6C2104020	R6C2105020	R6C2106020
22	R6C2102022	R6C2120522	R6C2103022	R6C2104022	R6C2105022	R6C2106022
25	R6C2102025	R6C2120525	R6C2103025	R6C2104025	R6C2105025	R6C2106025
30	R6C2102030	R6C2120530	R6C2103030	R6C2104030	R6C2105030	R6C2106030
35	R6C2102035	R6C2120535	R6C2103035	R6C2104035	R6C2105035	R6C2106035
40	R6C2102040	R6C2120540	R6C2103040	R6C2104040	R6C2105040	R6C2106040
45	R6C2102045	R6C2120545	R6C2103045	R6C2104045	R6C2105045	R6C2106045
50	R6C2102050	R6C2120550	R6C2103050	R6C2104050	R6C2105050	R6C2106050
55			R6C2103055	R6C2104055	R6C2105055	R6C2106055
60			R6C2103060	R6C2104060	R6C2105060	R6C2106060
65			R6C2103065	R6C2104065	R6C2105065	R6C2106065
70			R6C2103070	R6C2104070	R6C2105070	R6C2106070
75			R6C2103075	R6C2104075	R6C2105075	R6C2106075
80			R6C2103080	R6C2104080	R6C2105080	R6C2106080
90			R6C2103090	R6C2104090	R6C2105090	R6C2106090
100			R6C2103100	R6C2104100	R6C2105100	R6C2106100

Sizes in BLUE are non-preferred. Availability is limited and MOQ is applied. Data is strictly informative

Note: All Austenitic Stainless-Steel Fasteners may exhibit some Magnetic Properties due to the Manufacturing Process.

Refer: ISO 3506-2 Annex F

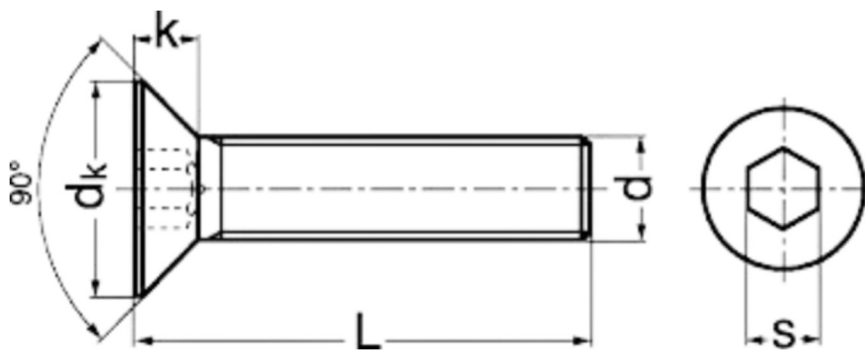

Note: *Non standard parts

Parameter↓/Dia→	M8x1.25	M10x1.5	M12x1.75	M16x2.0	M20x2.5	M24x3.0
dk Max	17.92	22.40	26.88	33.60	40.32	41.00
dk Min	15.24	19.22	23.12	29.01	35.38	38.38
Socket A/F s	5.00	6.00	8.00	10.00	12.00	14.00
S	5.00	6.00	8.00	10.00	12.00	14.00
k Max	5.06	6.30	7.54	8.90	10.26	14.10
t Max	3.50	4.40	4.60	5.30	5.90	10.30

Quote the PART NUMBER given below with your order/ inquiries:

All Dimensions in mm

Length↓/Dia→	M8x1.25	M10x1.5	M12x1.75	M16x2.0	M20x2.5	M24x3.0
10	R6C2108010					
12	R6C2108012	R6C2110012				
14	R6C2108014	R6C2110014				
16	R6C2108016	R6C2110016	R6C2112016			
18	R6C2108018	R6C2110018	R6C2112018			
20	R6C2108020	R6C2110020	R6C2112020	R6C2116020		
22	R6C2108022	R6C2110022	R6C2112022			
25	R6C2108025	R6C2110025	R6C2112025	R6C2116025		
30	R6C2108030	R6C2110030	R6C2112030	R6C2116030	R6C2120030	
35	R6C2108035	R6C2110035	R6C2112035	R6C2116035	R6C2120035	
40	R6C2108040	R6C2110040	R6C2112040	R6C2116040	R6C2120040	R6C2124040
45	R6C2108045	R6C2110045	R6C2112045	R6C2116045	R6C2120045	R6C2124045
50	R6C2108050	R6C2110050	R6C2112050	R6C2116050	R6C2120050	R6C2124050
55	R6C2108055	R6C2110055	R6C2112055	R6C2116055	R6C2120055	R6C2124055
60	R6C2108060	R6C2110060	R6C2112060	R6C2116060	R6C2120060	R6C2124060
65	R6C2108065	R6C2110065	R6C2112065	R6C2116065	R6C2120065	R6C2124065
70	R6C2108070	R6C2110070	R6C2112070	R6C2116070	R6C2120070	R6C2124070
75	R6C2108075	R6C2110075	R6C2112075	R6C2116075	R6C2120075	R6C2124075
80	R6C2108080	R6C2110080	R6C2112080	R6C2116080	R6C2120080	R6C2124080
90	R6C2108090	R6C2110090	R6C2112090	R6C2116090	R6C2120090	R6C2124090
100	R6C2108100	R6C2110100	R6C2112100	R6C2116100	R6C2120100	R6C2124100

Sizes in BLUE are non-preferred. Availability is limited and MOQ is applied. Data is strictly informative

Note: All Austenitic Stainless-Steel Fasteners may exhibit some Magnetic Properties due to the Manufacturing Process.

Refer: ISO 3506-2 Annex F