



GST NO.: 29AHZPU5620Q1ZZ

An ISO 9001:2015 Certified Company

# ROYAL INDUSTRIAL SUPPLIERS

QUALITY FASTENERS SPECIALIST



8310165941 / 9959457863



sales@royalfastenersindia.com



www.royalfastenersindia.com

## TECHNICAL DATA SHEET

### SWING EYE BOLT



MATERIAL- STAINLESS STEEL

GRADE-SS316 (A4-70)

AS PER-DIN-444

CATALOGUE NO. R6G70S

### INSTALLATION GUIDE

- VERIFY THE SWING EYE BOLT SIZE, THREAD TYPE, AND LOAD RATING MATCH THE APPLICATION REQUIREMENT.
- INSPECT THE SWING EYE BOLT FOR CRACKS, WEAR, OR DEFORMATION BEFORE INSTALLATION.
- ENSURE THE MATING HOLE OR THREADED INSERT IS CLEAN, DRY, AND FREE FROM BURRS OR CONTAMINATION.
- CONFIRM THAT THE BASE MATERIAL IS STRUCTURALLY CAPABLE OF SUPPORTING DYNAMIC AND SWIVEL LOADS.
- ALIGN THE THREAD OF THE SWING EYE BOLT WITH THE MATING HOLE BEFORE INSERTION.
- INSERT AND START THREADING BY HAND TO PREVENT CROSS-THREADING.
- USE APPROPRIATE TOOLING ON THE SHANK OR HEX BASE (IF PROVIDED), NOT ON THE SWIVEL EYE.
- TIGHTEN THE SWING EYE BOLT TO THE SPECIFIED TORQUE VALUE USING A SUITABLE TOOL.
- ENSURE THE SWIVEL EYE IS FREE TO ROTATE AFTER INSTALLATION WITHOUT OBSTRUCTION.
- POSITION THE EYE IN THE CORRECT LOAD DIRECTION FOR SAFE OPERATION.
- AVOID SIDE LOADING BEYOND THE RATED ANGULAR SWIVEL LIMIT.
- DO NOT OVERTIGHTEN, AS IT MAY RESTRICT SWIVEL MOVEMENT OR DAMAGE THREADS.
- VERIFY FULL SEATING AND SECURE ENGAGEMENT IN THE MATING MATERIAL.
- INSPECT THE FINAL INSTALLATION FOR SMOOTH ROTATION, PROPER ALIGNMENT, AND SAFE WORKING CONDITION.

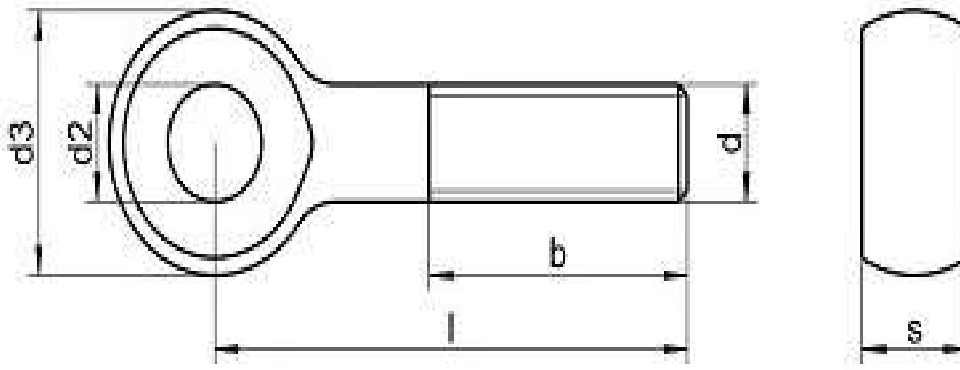

Size → Parameter↓	M5x0.8	M6x1.0	M8x1.25	M10x1.5	M12x1.75	M16x2.0	M20x2.5	M24x3.0
<b>d2 max</b>	5.030	6.030	8.036	10.036	12.043	16.043	18.043	22.052
<b>d2 min</b>	5.00	6.00	8.00	10.00	12.00	16.00	20.00	24.00
<b>d3 max</b>	12.00	14.00	18.00	20.00	25.00	32.00	40.00	45.00
<b>d3 min</b>	10.90	12.90	16.90	18.70	23.70	30.40	38.40	43.40
<b>b min</b>	16.00	18.00	22.00	26.00	30.00	36.00	44.00	52.00
<b>s nom</b>	5.00	6.00	8.00	10.00	12.00	16.00	20.00	24.00

Quote the PART NUMBER given below with your order/ inquiries:

All Dimensions in mm

Size→ Length↓	M5x0.8	M6x1.0	M8x1.25	M10x1.5	M12x1.75	M16x2.0	M20x2.5	M24x3.0
<b>30</b>	R6G70S05030	R6G70S06030						
<b>40</b>	R6G70S05040	R6G70S06040	R6G70S08040	R6G70S10040				
<b>50</b>	R6G70S05050	R6G70S06050	R6G70S08050	R6G70S10050	R6G70S12050	R6G70S16050	R6G70S20050	
<b>60</b>	R6G70S06060	R6G70S06060	R6G70S08060	R6G70S10060	R6G70S12060	R6G70S16060	R6G70S20060	
<b>75</b>	R6G70S05075	R6G70S06075	R6G70S08075	R6G70S10075	R6G70S12075	R6G70S16075	R6G70S20075	R6G70S24075
<b>90</b>	R6G70S05090	R6G70S06090	R6G70S08090	R6G70S10090	R6G70S12090	R6G70S16090	R6G70S20090	R6G70S24090
<b>100</b>	R6G70S05100	R6G70S06100	R6G70S08100	R6G70S10100	R6G70S12100	R6G70S16100	R6G70S20100	R6G70S24100
<b>125</b>		R6G70S06125	R6G70S08125	R6G70S10125	R6G70S12125	R6G70S16125	R6G70S20125	R6G70S24125
<b>150</b>		R6G70S06150	R6G70S08150	R6G70S10150	R6G70S12150	R6G70S16150	R6G70S20150	R6G70S24150
<b>175</b>			R6G70S08175	R6G70S10175	R6G70S12175	R6G70S16175	R6G70S20175	R6G70S24175
<b>200</b>			R6G70S08200	R6G70S10200	R6G70S12200	R6G70S16200	R6G70S20200	R6G70S24200

Sizes in BLUE are non-preferred. Availability is limited and MOQ is applied

Data is strictly informative

Note: All Austenitic Stainless-Steel Fasteners may exhibit some Magnetic Properties due to the Manufacturing Process.

Refer: ISO 3506-2 Annex F