



GST NO.: 29AHZPU5620Q1ZZ

An ISO 9001:2015 Certified Company

ROYAL INDUSTRIAL SUPPLIERS

QUALITY FASTENERS SPECIALIST



8310165941 / 9959457863



sales@royalfastenersindia.com



www.royalfastenersindia.com

TECHNICAL DATA SHEET

WING SCREW



MATERIAL- STAINLESS STEEL

GRADE-SS304 (A2-70)

AS PER-DIN-316A

CATALOGUE NO. R4W39

INSTALLATION GUIDE

- VERIFY THE WING SCREW SIZE, THREAD TYPE, AND LENGTH MATCH THE APPLICATION REQUIREMENT.
- INSPECT THE WING SCREW FOR THREAD DAMAGE, DEFORMATION, OR SURFACE DEFECTS BEFORE INSTALLATION.
- ENSURE THE MATING THREADED HOLE OR NUT IS CLEAN AND FREE FROM BURRS, DIRT, OR CONTAMINATION.
- ALIGN THE COMPONENTS TO BE FASTENED BEFORE INSERTING THE WING SCREW.
- INSERT THE WING SCREW INTO THE THREADED HOLE OR MATING NUT.
- START THREADING BY HAND TO ENSURE PROPER THREAD ENGAGEMENT AND PREVENT CROSS-THREADING.
- USE THE WINGS TO ROTATE THE SCREW CLOCKWISE UNTIL IT CONTACTS THE MATING SURFACE.
- CONTINUE HAND-TIGHTENING UNTIL THE REQUIRED CLAMPING FORCE IS ACHIEVED.
- ENSURE THE WINGS ARE POSITIONED FOR EASY ACCESS IF FUTURE ADJUSTMENT IS REQUIRED.
- DO NOT USE EXCESSIVE FORCE OR TOOLS UNLESS SPECIFICALLY REQUIRED BY THE APPLICATION.
- AVOID OVERTIGHTENING TO PREVENT THREAD DAMAGE OR DEFORMATION OF THE COMPONENTS.
- VERIFY THAT THE SCREW IS FULLY SEATED AND SECURELY FASTENED.
- CHECK THAT THE ASSEMBLED COMPONENTS ARE PROPERLY ALIGNED AND FREE FROM MOVEMENT.
- INSPECT THE FINAL INSTALLATION FOR PROPER SEATING, THREAD ENGAGEMENT, AND STABILITY.
- PERFORM PERIODIC INSPECTIONS IN APPLICATIONS SUBJECTED TO VIBRATION OR FREQUENT ADJUSTMENT.

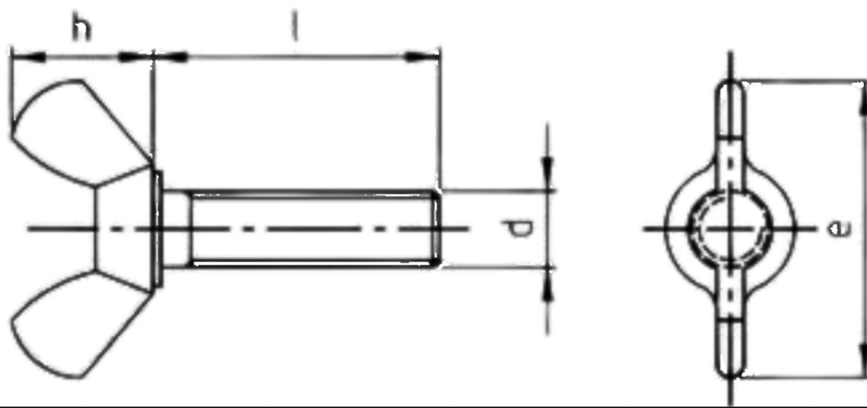

Size	M3x0.5	M4x0.7	M5x0.8	M6x1.0	M8 x1.25	M10x1.5	M12x1.75
Wing height h	8.80	9.50	10.50	12.90	14.80	17.30	22.30
Wing width e	18.00	21.00	22.00	26.80	30.30	35.30	47.50

Quote the PART NUMBER given below with your order/ inquiries:

All Dimensions in mm

Size→ Length↓	M3x0.5	M4x0.7	M5x0.8	M6x1.0	M8 x1.25	M10x1.5	M12x1.75
8	R4W3903008	R4W3904008	R4W3905008				
10	R4W3903010	R4W3904010	R4W3905010				
12	R4W3903012	R4W3904012	R4W3905012	R4W3906012			
16	R4W3903016	R4W3904016	R4W3905016	R4W3906016	R4W3908016	R4W3910016	R4W3912016
20	R4W3903020	R4W3904020	R4W3905020	R4W3906020	R4W3908020	R4W3910020	R4W3912020
25	R4W3903025	R4W3904025	R4W3905025	R4W3906025	R4W3908025	R4W3910025	R4W3912025
30	R4W3903030	R4W3904030	R4W3905030	R4W3906030	R4W3908030	R4W3910030	R4W3912030
35		R4W3904035	R4W3905035	R4W3906035	R4W3908035	R4W3910035	R4W3912035
40		R4W3904040	R4W3905040	R4W3906040	R4W3908040	R4W3910040	R4W3912040
45		R4W3904045	R4W3905045	R4W3906045	R4W3908045	R4W3910045	R4W3912045
50		R4W3904050	R4W3905050	R4W3906050	R4W3908050	R4W3910050	R4W3912050
55			R4W3905055	R4W3906055	R4W3908055	R4W3910055	R4W3912055
60			R4W3905060	R4W3906060	R4W3908060	R4W3910060	R4W3912060

Sizes in BLUE are non-preferred. Availability is limited and MOQ is applied

Data is strictly informative

Note: All Austenitic Stainless-Steel Fasteners may exhibit some Magnetic Properties due to the Manufacturing Process.

Refer: ISO 3506-2 Annex F