



GST NO.: 29AHZPU5620Q1ZZ

An ISO 9001:2015 Certified Company

ROYAL INDUSTRIAL SUPPLIERS

QUALITY FASTENERS SPECIALIST



8310165941 / 9959457863



sales@royalfastenersindia.com



www.royalfastenersindia.com

TECHNICAL DATA SHEET

WING SCREW



MATERIAL- STAINLESS STEEL

GRADE-SS316 (A4-70)

AS PER-DIN-316A

CATALOGUE NO. R6W39

INSTALLATION GUIDE

- VERIFY THE WING SCREW SIZE, THREAD TYPE, AND LENGTH MATCH THE APPLICATION REQUIREMENT.
- INSPECT THE WING SCREW FOR THREAD DAMAGE, DEFORMATION, OR SURFACE DEFECTS BEFORE INSTALLATION.
- ENSURE THE MATING THREADED HOLE OR NUT IS CLEAN AND FREE FROM BURRS, DIRT, OR CONTAMINATION.
- ALIGN THE COMPONENTS TO BE FASTENED BEFORE INSERTING THE WING SCREW.
- INSERT THE WING SCREW INTO THE THREADED HOLE OR MATING NUT.
- START THREADING BY HAND TO ENSURE PROPER THREAD ENGAGEMENT AND PREVENT CROSS-THREADING.
- USE THE WINGS TO ROTATE THE SCREW CLOCKWISE UNTIL IT CONTACTS THE MATING SURFACE.
- CONTINUE HAND-TIGHTENING UNTIL THE REQUIRED CLAMPING FORCE IS ACHIEVED.
- ENSURE THE WINGS ARE POSITIONED FOR EASY ACCESS IF FUTURE ADJUSTMENT IS REQUIRED.
- DO NOT USE EXCESSIVE FORCE OR TOOLS UNLESS SPECIFICALLY REQUIRED BY THE APPLICATION.
- AVOID OVERTIGHTENING TO PREVENT THREAD DAMAGE OR DEFORMATION OF THE COMPONENTS.
- VERIFY THAT THE SCREW IS FULLY SEATED AND SECURELY FASTENED.
- CHECK THAT THE ASSEMBLED COMPONENTS ARE PROPERLY ALIGNED AND FREE FROM MOVEMENT.
- INSPECT THE FINAL INSTALLATION FOR PROPER SEATING, THREAD ENGAGEMENT, AND STABILITY.
- PERFORM PERIODIC INSPECTIONS IN APPLICATIONS SUBJECTED TO VIBRATION OR FREQUENT ADJUSTMENT.

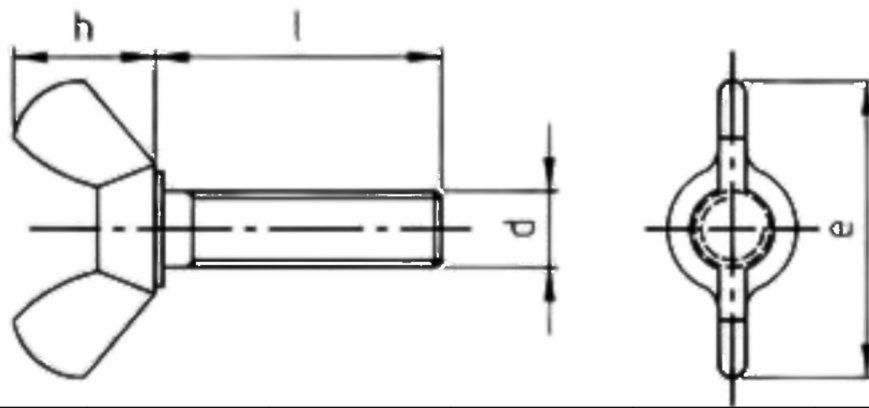

Size	M3x0.5	M4x0.7	M5x0.8	M6x1.0	M8 x1.25	M10x1.5	M12x1.75
Wing height h	8.80	9.50	10.50	12.90	14.80	17.30	22.30
Wing width e	18.00	21.00	22.00	26.80	30.30	35.30	47.50

Quote the PART NUMBER given below with your order/ inquiries:

All Dimensions in mm

Size→ Length↓	M3x0.5	M4x0.7	M5x0.8	M6x1.0	M8 x1.25	M10x1.5	M12x1.75
8	R6W3903008	R6W3904008	R6W3905008				
10	R6W3903010	R6W3904010	R6W3905010				
12	R6W3903012	R6W3904012	R6W3905012	R6W3906012			
16	R6W3903016	R6W3904016	R6W3905016	R6W3906016	R6W3908016	R6W3910016	R6W3912016
20	R6W3903020	R6W3904020	R6W3905020	R6W3906020	R6W3908020	R6W3910020	R6W3912020
25	R6W3903025	R6W3904025	R6W3905025	R6W3906025	R6W3908025	R6W3910025	R6W3912025
30	R6W3903030	R6W3904030	R6W3905030	R6W3906030	R6W3908030	R6W3910030	R6W3912030
35		R6W3904035	R6W3905035	R6W3906035	R6W3908035	R6W3910035	R6W3912035
40		R6W3904040	R6W3905040	R6W3906040	R6W3908040	R6W3910040	R6W3912040
45		R6W3904045	R6W3905045	R6W3906045	R6W3908045	R6W3910045	R6W3912045
50		R6W3904050	R6W3905050	R6W3906050	R6W3908050	R6W3910050	R6W3912050
55			R6W3905055	R6W3906055	R6W3908055	R6W3910055	R6W3912055
60			R6W3905060	R6W3906060	R6W3908060	R6W3910060	R6W3912060

Sizes in BLUE are non-preferred. Availability is limited and MOQ is applied

Data is strictly informative

Note: All Austenitic Stainless-Steel Fasteners may exhibit some Magnetic Properties due to the Manufacturing Process.

Refer: ISO 3506-2 Annex F